



POPULAR PRODUCT GUIDE

TEL : 02380 811937

www.pml-lifting.co.uk

MORGAN'S YARD, BARTLEY, HAMPSHIRE, SO40 2LH

Large Dee Shackle - Quality Range

with type A screw collar pin



Material: Body and pin high tensile steel
Safety Factor: MBL equals 5 x WLL
Standard: B.S.3032 table 2 - 1958
Finish: Self colour
Certificate: As standard an EC declaration of conformity is supplied, also upon request a certificate of basic raw material

working load limit	diameter bow	diameter pin	diameter eye	inside width	inside length	product code	weight each
tons	a inch	b inch	c inch	d inch	e inch		kg
0.25	1/4	3/8	3/4	1/2	1	10001A	0.06
0.50	3/8	1/2	1	3/4	1.1/2	10002A	0.16
0.75	1/2	5/8	1.1/4	1.1/8	2.1/8	10003A	0.35
1.50	5/8	3/4	1.1/2	1.1/4	2.1/2	10004A	0.63
2.00	3/4	7/8	1.3/4	1.1/2	2.7/8	10005A	1.00
3.00	7/8	1	2	1.3/4	3.1/4	10006A	1.54
3.75	1	1.1/8	2.1/4	2	3.3/4	10007A	2.21
5.00	1.1/8	1.1/4	2.1/2	2.1/8	4.1/8	10008A	3.11
6.00	1.1/4	1.3/8	2.3/4	2.3/8	4.1/2	10009A	4.33
7.00	1.3/8	1.1/2	3	2.5/8	5	10010A	5.33
9.50	1.1/2	1.3/4	3.1/2	2.3/4	5.3/8	10011A	8.46
11.25	1.5/8	1.7/8	3.3/4	3	5.3/4	10012A	10.48
13.00	1.3/4	2	4	3.1/4	6.1/8	10013A	12.66
14.25	1.7/8	2.1/8	4.1/4	3.5/8	7	10014A	15.34
16.25	2	2.1/4	4.1/2	3.7/8	7.3/8	10015A	18.50
18.00	2.1/8	2.3/8	4.3/4	4.1/8	7.3/4	10016A	23.80
20.00	2.1/4	2.1/2	5	4.1/4	8.1/4	10017A	28.60

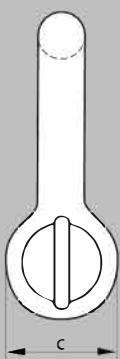
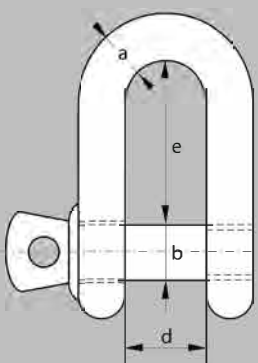

Large Bow Shackles - Quality Range

with type A screw collar pin



Material: Body and pin high tensile steel
Safety Factor: MBL equals 5 x WLL
Standard: B.S.3032 table 3 - 1958
Finish: Self colour
Certificate: As standard an EC declaration of conformity is supplied, also upon request a certificate of basic raw material

working load limit	diameter bow	diameter pin	diameter eye	inside width	inside length	width bow	product code	weight each
tons	a inch	b inch	c inch	d inch	e inch	f inch		kg
0.15	1/4	3/8	3/4	1/2	1.1/8	3/4	10301A	0.08
0.45	3/8	1/2	1	5/8	1.5/8	1	10302A	0.18
0.75	1/2	5/8	1.1/4	7/8	2.1/8	1.1/4	10303A	0.34
1.25	5/8	3/4	1.1/2	1.1/8	2.3/4	1.5/8	10304A	0.65
2.00	3/4	7/8	1.3/4	1.3/8	3.3/8	2	10305A	1.08
2.75	7/8	1	2	1.5/8	3.7/8	2.1/4	10306A	1.80
3.75	1	1.1/8	2.1/4	1.3/4	4.1/4	2.1/2	10307A	2.46
4.75	1.1/8	1.1/4	2.1/2	2	4.7/8	2.7/8	10308A	3.47
5.75	1.1/4	1.3/8	2.3/4	2.1/4	5.3/8	3.1/4	10309A	4.56
7.25	1.3/8	1.1/2	3	2.1/2	6	3.1/2	10310A	6.07
8.50	1.1/2	1.3/4	3.1/2	2.3/4	6.5/8	3.7/8	10311A	8.35
9.50	1.5/8	1.7/8	3.3/4	3	7.3/8	4.3/8	10312A	11.81
11.50	1.3/4	2	4	3.3/8	8.1/8	4.3/4	10313A	14.32
13.00	1.7/8	2.1/8	4.1/4	3.5/8	8.3/7	5.1/8	10314A	17.03
15.00	2	2.1/4	4.1/2	3.7/8	9.3/8	5.1/2	10315A	20.00

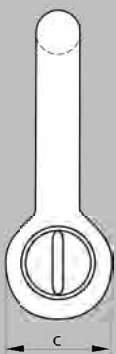
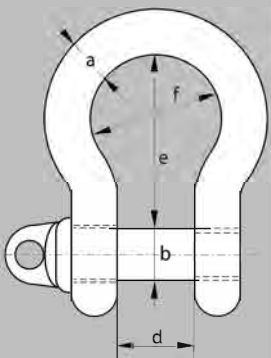

Large Dee Shackles - Quality Range

with type E bolt and nut pin



Material: Body and pin high tensile steel
Safety Factor: MBL equals 5 x WLL
Standard: B.S.3032 table 2 - 1958
Finish: Self colour
Certificate: As standard an EC declaration of conformity is supplied, upon request a certificate of basic raw material
Notes: Hot dipped galvanised also available - prices on request

working load limit	diameter bow	diameter pin	diameter eye	inside width	inside length	product code	weight each
tons	a inch	b inch	c inch	d inch	e inch		kg
0.25	1/4	3/8	3/4	1/2	1	14001	0.10
0.50	3/8	1/2	1	3/4	1.1/2	14002	0.20
0.75	1/2	5/8	1.1/4	1.1/8	2.1/8	14003	0.50
1.50	5/8	3/4	1.1/2	1.1/4	2.1/2	14004	0.68
2.00	3/4	7/8	1.3/4	1.1/2	2.7/8	14005	1.30
3.00	7/8	1	2	1.3/4	3.1/4	14006	1.80
3.75	1	1.1/8	2.1/4	2	3.3/4	14007	2.80
5.00	1.1/8	1.1/4	2.1/2	2.1/8	4.1/8	14008	3.68
6.00	1.1/4	1.3/8	2.3/4	2.3/8	4.1/2	14009	4.92
7.00	1.3/8	1.1/2	3	2.5/8	5	14010	6.00
9.50	1.1/2	1.3/4	3.1/2	2.3/4	5.3/8	14011	9.50
11.25	1.5/8	1.7/8	3.3/4	3	5.3/4	14012	11.56
13.00	1.3/4	2	4	3.1/4	6.1/8	14013	14.92
14.25	1.7/8	2.1/8	4.1/4	3.5/8	7	14014	16.36
16.25	2	2.1/4	4.1/2	3.7/8	7.3/8	14015	19.88
18.00	2.1/8	2.3/8	4.3/4	4.1/8	7.3/4	14016	25.22
20.00	2.1/4	2.1/2	5	4.1/4	8.1/4	14017	29.86

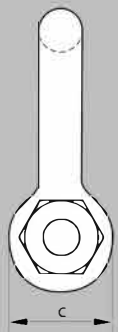
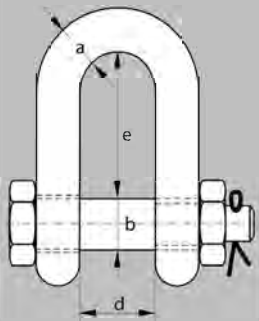

Large Bow Shackles - Quality Range

with type E bolt and nut pin



Material: Body and pin high tensile steel
 Safety Factor: MBL equals 5 x WLL
 Standard: B.S.3032 table 3 - 1958
 Finish: Self colour
 Certificate: As standard an EC declaration of conformity is supplied, upon request a certificate of basic raw material
 Notes: Hot dipped galvanised also available - prices on request

working load limit	diameter bow	diameter pin	diameter eye	inside width	inside length	width bow	product code	weight each
tons	a inch	b inch	c inch	d inch	e inch	f inch		kg
0.15	1/4	3/8	3/4	1/2	1.1/8	3/4	14201	0.09
0.45	3/8	1/2	1	5/8	1.5/8	1	14202	0.21
0.75	1/2	5/8	1.1/4	7/8	2.1/8	1.1/4	4203	0.40
1.25	5/8	3/4	1.1/2	1.1/8	2.3/4	1.5/8	14204	0.70
2.00	3/4	7/8	1.3/4	1.3/8	3.3/8	2	14205	1.25
2.75	7/8	1	2	1.5/8	3.7/8	2.1/4	14206	2.00
3.75	1	1.1/8	2.1/4	1.3/4	4.1/4	2.1/2	14207	2.85
4.75	1.1/8	1.1/4	2.1/2	2	4.7/8	2.7/8	14208	3.94
5.75	1.1/4	1.3/8	2.3/4	2.1/4	5.3/8	3.1/4	420	i:
7.25	1.3/8	1.1/2	3	2.1/2	6	3.1/2		
8.50	1.1/2	1.3/4	3.1/2	2.3/4	6.5/8	3.7/8	14211	9.45
9.50	1.5/8	1.7/8	3.3/4	3	7.3/8	4.3/8	14212	12.67
11.50	1.3/4	2	4	3.3/8	8.1/8	4.3/4	14213	15.85
13.00	1.7/8	2.1/8	4.1/4	3.5/8	8.3/4	5.1/8	14214	18.80
15.00	2	2.1/4	4.1/2	3.7/8	9.3/8	5.1/2	14215	21.56

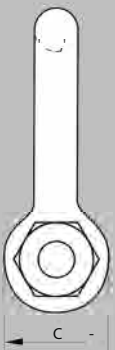
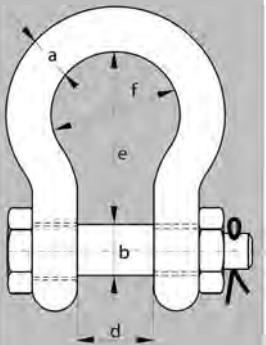

Yellow Pin Bow Shackles - Economy Range

with safety bolt

Material: Bow and pin high tensile steel, Grade 6
 Standard: Generally to US FedSpec RR-C-271
 Finish: Hot dippedgalvanised
 Certificate: As standard an EC declaration of conformity is supplied, also uponrequest a certificate of basicraw material

working load limit	diameter bow	diameter pin	diameter eye	inside width	inside length	width bow	product code	weight each
tons	a mm	b mm	c mm	d mm	e mm	f mm		kg
0.50	6	8	16	12	29	20	12032(0.06
0.75	8	10	19	13.5	31	21	12033(0.10
1.00	10	11	23	17	37	26	12034(0.16
1.50	11	13	27	19	43	29	12035(0.22
2.00	13	16	30	20	48	33	12036(0.36
3.25	16	19	38	27	60	43	12037(0.76
4.75	19	22	46	32	71	so	12038(1.23
6.50	22	25	53	36	84	58	12039(1.79
8.50	25	28	61	43	95	68	12040(2.57
9.50	28	32	68	46	108	74	12041(3.75
12.00	32	35	76	51	119	82	12042(5.32
13.50	35	38	84	57	133	92	12043(7.19
17.00	38	42	92	60	146	98	12044(9.44
25.00	45	so	106	73	177	127	12045(15.40
35.00	so	57	119	83	197	138	12046(20.06
55.00	65	70	145	105	260	185	12048(41.40

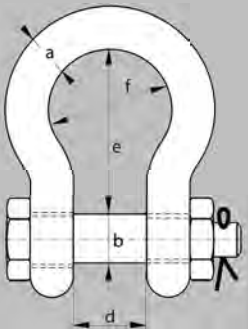

Yellow Pin Bow Shackles - Economy Range

with screw collar pin



Material: Bow and pin high tensile steel, Grade 6
Standard: Generally to US Fed Spec RR-C-271
Finish: Hot dipped galvanised
Certificate: As standard an EC declaration of conformity is supplied, also upon request a certificate of basic raw material

working load limit	diameter bow	diameter pin	diameter eye	inside width	inside length	width bow	product code	weight each
tons	a mm	b mm	c mm	d mm	e mm	f mm		kg
0.33	5	6	14	9.5	22	15	11001C	0.03
0.50	6	8	16	12	29	20	11002C	0.05
0.75	8	10	19	13.5	31	21	11003C	0.09
1.00	10	11	23	17	37	26	11004C	0.14
1.50	11	13	27	19	43	29	11005C	0.17
2.00	13	16	30	20	48	33	11006C	0.33
3.25	16	19	38	27	60	43	11007C	0.62
4.75	19	22	46	32	71	50	11008C	1.07
6.50	22	25	53	36	84	58	11009C	1.64
8.50	25	28	61	43	95	68	11010C	2.28
9.50	28	32	68	46	108	74	11011C	3.36
12.00	32	35	76	51	119	82	11012C	4.31
13.50	35	38	84	57	133	92	11013C	6.14
17.00	38	42	92	60	146	98	11014C	7.81
25.00	45	50	106	73	177	127	11015C	12.61
35.00	50	57	119	83	197	138	11016C	18.33
55.00	65	70	145	105	260	185	11018C	37.90

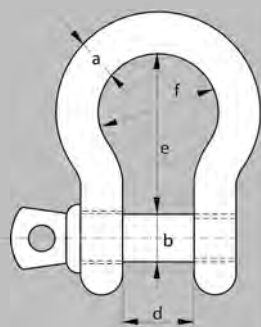

Green Pin® Standard Bow Shackles G-4163

with safety bolt

Material: Body and pin high tensile steel, Grade 6, quenched and tempered
 Safety Factor: MBL equals 6 x WLL
 Standard: EN 13889 and meets performance requirements of US Fed Spec RR-C-271, Type IVA Class 3, Grade A
 Finish: Hot dipped galvanised
 Temp Range: Minus 20°c up to 200°c
 Certificate: As above

working load limit	bow dia	pin dia	eye dia	width eye	width inside	length inside	width bow	length	length bolt	width bow	width	product code	weight each
tons	a mm	b mm	c mm	d mm	e mm	f mm	g mm	h mm	i mm	j mm	k mm		kg
0.5	7	8	16.5	7	12	29	20	48.5	42	34	4	12032A	0.06
0.75	9	10	20	9	13.5	32	22	56	50	40	5	12033A	0.11
1	10	11	22.5	10	17	36.5	26	63.5	60	46	8	12034A	0.16
1.5	11	13	26.5	11	19	43	29	74	67	51	11	12035A	0.22
2	13.5	16	34	13.5	22	51	32	89	82	58	13	12036A	0.42
3.25	16	19	40	16	27	64	43	110	98	75	17	12037A	0.74
4.75	19	22	46	19	31	76	51	129	114	89	19	12038A	1.18
6.5	22	25	52	22	36	83	58	144	130	102	22	12039A	1.77
8.5	25	28	59	25	43	95	68	164	150	118	25	12040A	2.58
9.5	28	32	66	28	47	108	75	185	166	131	27	12041A	3.66
12	32	35	72	32	51	115	83	201	178	147	30	12042A	4.91
13.5	35	38	80	35	57	133	92	227	197	162	33	12043A	6.54
17	38	42	88	38	60	146	99	249	202	175	33	12044A	8.19
25	45	50	103	45	74	178	126	300	249	216	23	12045A	14.22
35	50	57	111	50	83	197	138	331	269	238	26	12046A	19.85
42.5	57	65	130	57	95	222	160	377	301	274	29	12047A	28.33
55	65	70	145	65	105	260	180	433	330	310	32	12048A	39.59
85	75	83	162	73	127	329	190	527	380	340	39	12049A	62.00

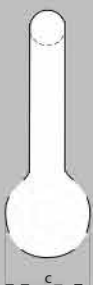
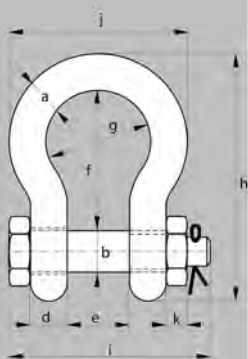

Green Pin® Standard Bow Shackles G-4161

with screw collar pin



Material: Body and pin high tensile steel, Grade 6, quenched and tempered
Safety Factor: MBL equals 6 x WLL
Standard: EN 13889 and meets performance requirements of US Fed Spec RR-C-271, Type IVA Class 2, Grade A
Finish: Hot dipped galvanised
Temp Range: Minus 20°C up to 200°C
Certificate: As standard an EC declaration of conformity is supplied, also upon request a basic raw material cert, manufacturer test cert, inspection cert and DNV cert (2t above)

working load limit	bow dia	pin dia	eye dia	width eye	width inside	length inside	width bow	length	length bolt	width bow	product code	weight each
tons	a mm	b mm	c mm	d mm	e mm	f mm	g mm	h mm	i mm	j mm		kg
0.33	5	6	12	5	9.5	22	16	36	29.5	26	11001A	0.02
0.5	7	8	16.5	7	12	29	20	48.5	38	34	11002A	0.05
0.75	9	10	20	9	13.5	32	22	56	46.5	40	11003A	0.10
1	10	11	22.5	10	17	36.5	26	63.5	54	46	11004A	0.14
1.5	11	13	26.5	11	19	43	29	74	59.5	51	11005A	0.19
2	13.5	16	34	13	22	51	32	89	73	58	11006A	0.36
3.25	16	19	40	16	27	64	43	110	89	75	11007A	0.63
4.75	19	22	46	19	31	76	51	129	103	89	11008A	1.01
6.5	22	25	52	22	36	83	58	144	119	102	11009A	1.50
8.5	25	28	59	25	43	95	68	164	137	118	11010A	2.21
9.5	28	32	66	28	47	108	75	185	153	131	11011A	3.16
12	32	35	72	32	51	115	83	201	170	147	11012A	4.31
13.5	35	38	80	35	57	133	92	227	186	162	11013A	5.55
17	38	42	88	38	60	146	99	249	203	175	11014A	7.43
25	45	50	103	45	74	178	126	300	243	216	11015A	12.84
35	50	57	111	50	83	197	138	331	272	28	11016A	18.15
42.5	57	65	130	57	95	222	160	377	310	274	11017A	26.29
55	65	70	145	65	105	260	185	433	344	310	11018A	37.60

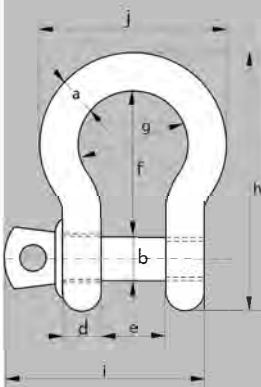

Yellow Pin Dee Shackles - Economy Range

with safety bolt

Material: Bow and pin high tensile steel, Grade 6
Standard: Generally to US Fed Spec RR-C-271
Finish: Hot dipped galvanised
Certificate: As standard an EC declaration of conformity is supplied, also upon request a certificate of basic raw material

working load limit	diameter bow	diameter pin	diameter eye	inside width	inside length	product code	weight each
tons	a mm	b mm	c mm	d mm	e mm		kg
2.00	13	16	30	20	41	12536C	0.34
3.25	16	19	38	27	51	12537C	0.67
4.75	19	22	46	32	60	12538C	1.14
6.50	22	25	53	36	71	12539C	1.75
8.50	25	28	61	43	81	12540C	2.52
9.50	28	32	68	46	90	12541C	3.45
12.00	32	35	76	51	100	12542C	4.91
13.50	35	38	84	57	111	12543C	6.24
17.00	38	42	92	60	122	12544C	8.40
25.00	45	50	106	73	146	12545C	14.26
35.00	50	57	119	83	171	12546C	18.53
55.00	65	70	145	105	203	12548C	35.33

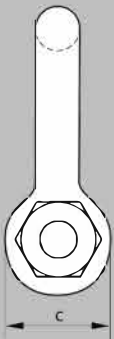
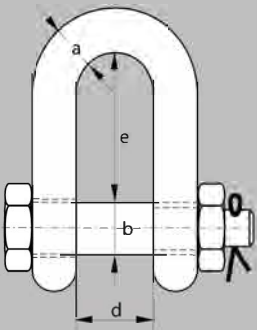

Yellow Pin Dee Shackles - Economy Range

with screw collar pin

Material: Bow and pin high tensile steel, Grade 6
Standard: Generally to US Fed Spec RR-C-271
Finish: Hot dipped galvanised
Certificate: As standard an EC declaration of conformity is supplied, also upon request a certificate of basic raw material

working load limit	diameter bow	diameter pin	diameter eye	inside width	inside length	product code	weight each
tons	a mm	b mm	c mm	d mm	e mm		kg
0.50	6	8	16	12	22	11502C	0.05
0.75	8	10	19	13.5	26	11503C	0.08
1.00	10	11	23	17	32	11504C	0.13
1.50	11	13	27	19	37	11505C	0.20
2.00	13	16	30	20	41	11506C	0.27
3.25	16	19	38	27	51	11507C	0.57
4.75	19	22	46	32	60	11508C	1.19
6.50	22	25	53	36	71	11509C	1.43
8.50	25	28	61	43	81	11510C	2.16
9.50	28	32	68	46	90	11511C	3.06
12.00	32	35	76	51	100	11512C	4.11
13.50	35	38	84	57	111	11513C	5.28
17.00	38	42	92	60	122	11514C	7.24
25.00	45	50	106	73	146	11515C	12.14
35.00	50	57	119	83	171	11516C	16.86
55.00	65	70	145	105	203	11518C	32.65

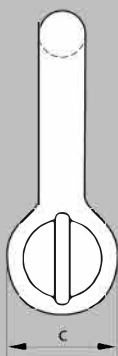
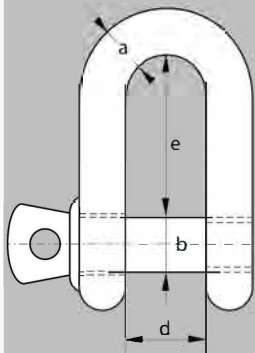

Green Pin® Standard Dee Shackles G-4153

with safety bolt

Material: Body and pin high tensile steel, Grade 6, quenched and tempered
Safety Factor: MBL equals 6 x WLL
Standard: EN 13889 and meets performance requirements of US Fed Spec RR-C-271, Type IVB Class 3, Grade A
Finish: Hot dipped galvanised
Temp Range: Minus 20°C up to 200°C
Certificate: As above

working load limit	bow dia	pin dia	eye dia	width eye	width inside	length inside	length	length bolt	width nut	product code	weight each
tons	a mm	b mm	c mm	d mm	e mm	f mm	g mm	h mm	i mm		kg
2	13.5	16	34	13	22	43	81	82	13	12536A	0.39
3.25	16	19	40	16	27	51	97	98	17	12537A	0.67
4.75	19	22	46	19	31	59	112	114	19	12538A	1.08
6.5	22	25	52	22	36	73	134	130	22	12539A	1.66
8.5	25	28	59	25	43	85	154	150	25	12540A	2.46
9.5	28	32	66	28	47	90	167	166	27	12541A	3.40
12	32	35	72	32	51	94	180	178	30	12542A	4.51
13.5	35	38	80	35	57	115	209	197	33	12543A	6.10
17	38	42	88	38	60	127	230	202	19	12544A	7.63
25	45	50	103	45	74	149	271	249	23	12545A	13.25
35	50	57	111	50	83	171	305	269	26	12546A	18.53
42.5	57	65	130	57	95	190	345	301	29	12547A	25.94
55	65	70	145	65	105	203	376	330	32	12548A	35.33
85	75	83	162	73	127	229	427	380	39	12549A	52.97

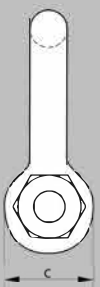
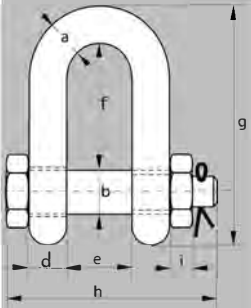
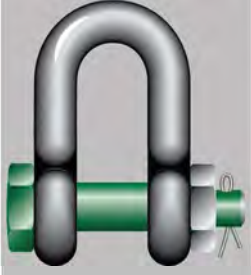

Green Pin® Standard Dee Shackles G-4151

with screw collar pin

Material: Body and pin high tensile steel, Grade 6, quenched and tempered
Safety Factor: MBL equals 6 x WLL
Standard: EN 13889 and meets performance requirements of US Fed Spec RR-C-271, Type IVB Class 2, Grade A
Finish: Hot dipped galvanised
Temp Range: Minus 20°C up to 200°C
Certificate: As standard an EC declaration of conformity is supplied, also upon request a basic raw material cert, manufacturer test cert, inspection cert and DNV cert (2t above)

working load limit	bow dia	pin dia	eye dia	width eye	width inside	length inside	length	length bolt	product code	weight each
tons	a mm	b mm	c mm	d mm	e mm	f mm	g mm	h mm		kg
0.33	5	6	12	5	9.5	19	33	29.5	11501A	0.02
0.5	7	8	16.5	7	12	22	41.5	38	11502A	0.05
0.75	9	10	20	9	13.5	26	50	46.5	11503A	0.09
1	10	11	22.5	10	17	32	59	54	11504A	0.14
1.5	11	13	26.5	11	19	37	68	59.5	11505A	0.19
2	13.5	16	34	13	22	43	81	73	11506A	0.32
3.25	16	19	40	16	27	51	97	89	11507A	0.54
4.75	19	22	46	19	31	59	112	103	11508A	0.87
6.5	22	25	52	22	36	73	134	119	11509A	1.34
8.5	25	28	59	25	43	85	154	137	11510A	2.08
9.5	28	32	66	28	47	90	167	153	11511A	2.77
12	32	35	72	32	51	94	180	170	11512A	3.72
13.5	35	38	80	35	57	115	209	186	11513A	5.14
17	38	42	88	38	60	127	230	203	11514A	6.85
25	45	50	103	45	74	149	271	243	11515A	11.45
35	50	57	111	50	83	171	305	272	11516A	16.86
42.5	57	65	130	57	95	190	345	310	11517A	24.61
55	65	70	145	65	105	203	376	344	11518A	32.65

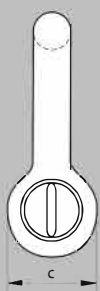
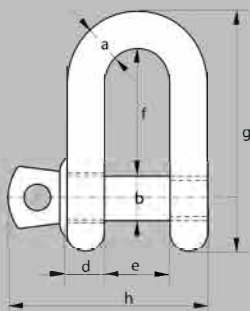

Piling Shackles

Long dee type with type A screw collar pin

Material: Bow and pin high tensile steel, Grade 4
Safety Factor: MBL equals 5 x WLL
Finish: Self colour
Certificate: As standard an EC declaration of conformity is supplied, upon request a certificate of basic raw material
Notes: Hot dipped galvanised also available - prices on request

working load limit	diameter bow	diameter pin	diameter eye	width inside	length inside	product code	weight each
tons	a mm	b mm	c mm	d mm	e mm		kg
1.00	13	16	32	22	152	15701	0.55
1.50	16	19	38	32	203	15702	0.95
2.00	19	22	45	38	203	15703	1.64
3.00	22	25	50	45	254	15704	2.29
3.75	25	28	57	50	254	15705	3.40
5.00	28	32	64	54	305	15706	5.05

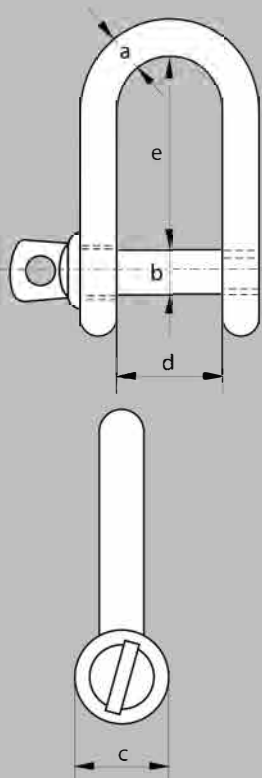

Collared Eyebolts - Quality Range

metric coarse thread

- Material:** BS970-080A27 hardened and tempered
Safety Factor: MBL equals 5 x SWL
Standard: BS4278 - table 1 - 1984
Finish: Self colour
Certificate: This product is supplied with an EC declaration of conformity, upon request a certificate of basic raw material
Note: Electro galvanised (zinc plated) also available - prices on request

safe working load	diameter thread	diameter base	diameter eye outside	diameter eye inside	thickness collar	height	thread length	product code	weight each
tonnes	a mm	b mm	c mm	e mm	f mm	g mm	h mm		kg
* 0.10	6	22	33	15	7	36	18	20001V	0.06
* 0.15	8	22	33	15	7	36	18	20002V	0.06
* 0.25	10	22	33	15	7	36	18	20003V	0.06
* 0.40	12	22	33	15	7	36	18	20004V	0.06
* 0.50	14	29	44	20	10	48	23	20005V	0.15
* 0.80	16	29	44	20	10	48	23	20006V	0.15
* 1.00	18	36	52	24	12	58	28	20007V	0.27
* 1.60	20	40	59	27	14	65	32	20008V	0.38
* 1.60	22	45	64	30	14	73	35	20009V	0.54
* 2.50	24	52	77	35	17	84	40	20010V	0.85
* 2.50	27	58	85	39	20	94	46	20011V	1.13
* 4.00	30	65	96	44	22	106	51	20012V	1.62
* 4.00	33	72	106	48	24	117	56	20013V	2.37
* 6.30	36	81	118	54	27	131	63	20014V	3.12
* 6.30	39	81	118	54	27	131	63	20015A	3.12
* 8.00	42	101	148	68	34	164	79	20016A	6.45
* 8.00	45	101	148	68	34	164	79	20017A	6.45
* 10.00	48	101	148	68	34	164	79	20018A	6.51
12.50	52	115	168	76	38	186	89	20019A	9.58
16.00	56	128	188	86	43	208	100	20020A	12.99
20.00	64	144	212	96	48	234	112	20021A	18.20

sizes marked * are additional and proportional to the specification

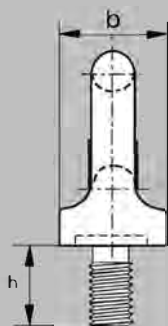
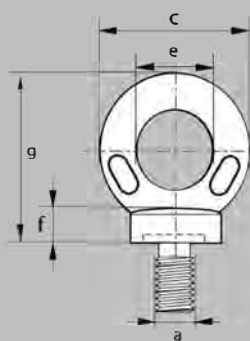

Collared Eyebolts - Quality Range

BSW thread

- Material:** BS970-080A27 hardened and tempered
Safety Factor: MBL equals 5 x SWL
Standard: BS4278 - table 4 - 1984
Finish: Self colour
Certificate: This product is supplied with an EC declaration of conformity, upon request a certificate of basic raw material
Note: Electro galvanised (zinc plated) also available - prices on request

safe working load	diameter thread	diameter base	diameter eye outside	diameter eye inside	thickness collar	height	thread length	product code	weight each
tonnes	a inch	b mm	c mm	e mm	f mm	g mm	h mm		kg
0.10	1/4	22	33	15	7	36	18	20101A	0.06
* 0.15	5/16	22	33	15	7	36	18	20102A	0.06
* 0.25	3/8	22	33	15	7	36	18	20103V	0.06
0.50	1/2	29	44	20	10	48	23	20105V	0.15
0.90	5/8	36	52	24	12	58	28	20107V	0.27
1.40	3/4	45	66	30	14	73	35	20108V	0.54
2.00	7/8	52	77	35	17	84	40	20109A	0.85
2.75	1	58	85	39	20	94	46	20110V	1.13
3.50	1.1/8	65	96	44	22	106	51	20111V	1.62
4.50	1.1/4	72	106	48	24	117	56	20112V	2.37
6.50	1.1/2	81	118	54	27	131	63	20114V	3.12
* 9.00	1.3/4	101	148	68	34	164	79	20116A	6.27
12.00	2	115	168	76	38	186	89	20118A	9.58

sizes marked * are additional and proportional to the specification

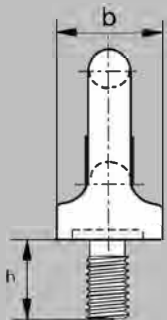
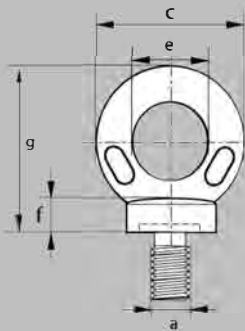

Long Shank Collared Eyebolts



BSW thread

Material: High tensile steel
Safety Factor: MBL equals 5 x SWL
Finish: Self colour
Certificate: This product is supplied with an EC declaration of conformity
Note: Electro galvanised (zinc plated) also available - prices on request

safe working load	diameter thread	diameter base	diameter eye outside	diameter eye inside	thickness collar	height	thread length	product code	weight each
tonnes	a inch	b inch	c inch	e inch	f inch	g inch	h inch		kg
0.25	3/8	27/32	1.5/16	9/16	9/32	1.3/8	7	21501A	0.18
0.50	1/2	1.1/8	1.5/8	3/4	3/8	1.3/4	7	21502A	0.25
* 0.90	5/8	1.13/32	2	15/16	15/32	2.1/4	7	21503A	0.44
* 1.40	3/4	1.11/16	2.7/16	1.1/8	9/16	2.3/4	7	21504A	0.70
2.00	7/8	1.31/32	2.13/16	1.5/16	21/32	2.7/8	7	21505A	1.05
2.75	1	2.1/4	3.1/4	1.1/2	3/4	3.7/16	7	21506A	1.50
3.50	1.1/8	2.13/16	4.1/8	1.7/8	15/16	4.1/2	7	21507A	2.80
4.50	1.1/4	2.13/16	4.1/8	1.7/8	15/16	4.1/2	7	21508A	2.90

* UNC thread also available upon request

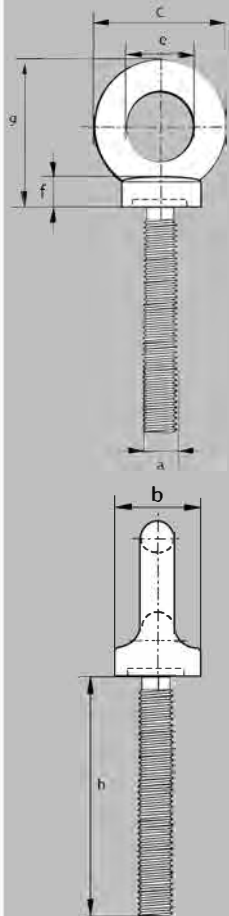

Collared Eyebolts - Quality Range

UNC thread

Material: BS970-080A27 hardened and tempered
Safety Factor: MBL equals 5 x SWL
Standard: BS4278 - table 4 - 1984
Finish: Self colour
Certificate: This product is supplied with an EC declaration of conformity, upon request a certificate of basic raw material
Note: Electro galvanised (zinc plated) also available - prices on request

safe working load	diameter thread	diameter base	diameter eye outside	diameter eye inside	thickness collar	height	thread length	product code	weight each
tonnes	a inch	b mm	c mm	e mm	f mm	g mm	h mm		kg
* 0.10	1/4	22	33	15	7	36	18	20201	0.06
* 0.15	5/16	22	33	15	7	36	18	20202	0.06
0.25	3/8	22	33	15	7	36	18	20203V	0.06
0.50	1/2	29	44	20	10	48	23	20205V	0.15
0.90	5/8	36	52	24	12	58	28	20207V	0.27
1.40	3/4	45	66	30	14	73	35	20208V	0.54
2.00	7/8	52	77	35	17	84	40	20209V	0.85
2.75	1	58	85	39	20	94	46	20210V	1.13
3.50	1.1/8	65	96	44	22	106	51	20211V	1.62
4.50	1.1/4	72	106	48	24	117	56	20212V	2.37
* 6.50	1.1/2	81	118	54	27	131	63	20214V	3.12
9.00	1.3/4	101	148	68	34	164	79	20216	6.27
12.00	2	115	168	76	38	186	89	20218	9.58

sizes marked * are additional and proportional to the specification

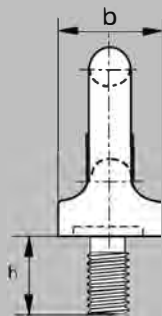
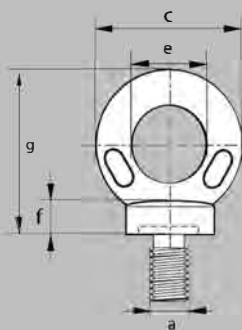

Long Shank Collared Eyebolts - Quality Range

metric coarse thread



- Material:** High tensile steel
Safety Factor: MBL equals 5 x SWL
Finish: Self colour
Certificate: This product is supplied with an EC declaration of conformity
Note: Electro galvanised (zinc plated) also available - prices on request

safe working load	diameter thread	diameter base	diameter eye outside	diameter eye inside	thickness collar	height	thread length	product code	weight each
tonnes	a mm	b mm	c mm	e mm	f mm	g mm	h mm		kg
0.25	10	22	33	15	7	36	178	21001V	0.18
0.40	12	28	41	19	11	45	178	21002V	0.25
0.50	14	36	52	24	14	58	178	21003A	0.40
0.80	16	36	52	24	14	58	178	21004V	0.44
1.00	18	43	62	29	17	69	178	21005A	0.70
1.60	20	43	62	29	17	69	178	21006V	0.70
1.60	22	50	73	33	17	74	178	21007A	1.05
2.50	24	57	82	38	19	87	178	21008A	1.50
4.00	30	71	104	48	24	116	178	21009A	2.80

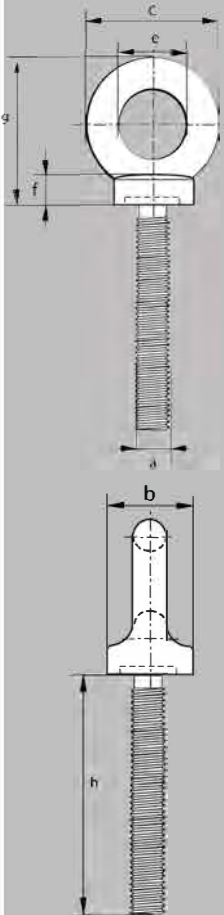

Collared Eyebolts

c/w reeveable egg link

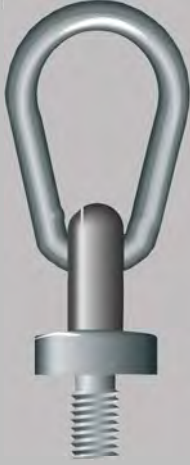

- Material:** Eyebolt: BS970-080A27 hardened and tempered
Link: high tensile steel
- Safety Factor:** MBL equals 5 x SWL
- Finish:** Self colour
- Certificate:** This product is supplied with an EC declaration of conformity, upon request a certificate of basic raw material
- Note:** For eyebolt dimensions refer to BS4278 tables 1 & 4

BSW thread

safe working load	diameter thread	diameter link	length link inside	width link inside	thread length	product code	weight each
tonnes	a inch	b inch	c inch	d inch	h mm		kg
0.25	3/8	7/16	2.3/4	1.3/8	18	24201	0.21
0.50	1/2	7/16	2.3/4	1.3/8	23	24202	0.29
0.90	5/8	5/8	4	2	28	24203	0.73
1.40	3/4	3/4	4.3/4	2.1/4	35	24204	1.19
2.75	1	7/8	5.3/8	2.5/8	40	24206	2.65

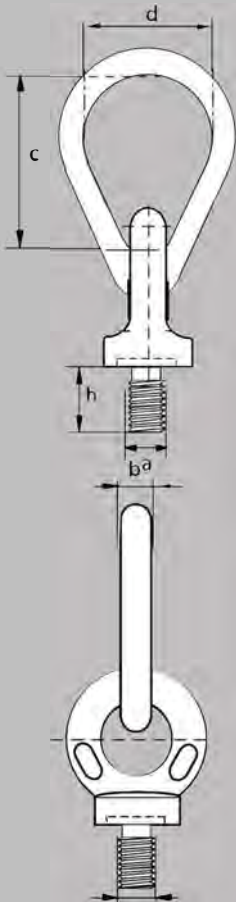

Eyebolts with Oval Link

metric coarse thread

Material: BS970-080A27 hardened and tempered
Safety Factor: MBL equals 5 x SWL
Standard: BS4278 - table 2 - 1984
Finish: Self colour
Certificate: This product is supplied with an EC declaration of conformity, upon request a certificate of basic raw material

safe working load	diameter thread	diameter link	length link inside	width link inside	height base to centre	thread length	diameter base	product code	weight each
tonnes	a mm	b mm	c mm	d mm	e mm	f mm	g mm		kg
* 0.10	8	13	53	24	20	27	39	24001	0.33
* 0.15	10	13	53	24	20	27	39	24002	0.35
* 0.20	12	13	53	24	20	27	39	24003	0.36
* 0.30	14	13	53	24	20	27	39	24004	0.37
* 0.40	16	13	53	24	20	27	39	24005	0.38
* 0.70	18	13	53	24	20	27	39	24006	0.39
* 1.00	20	13	53	24	20	27	39	24007	0.40
* 1.30	22	15	63	29	23	32	47	24008	0.65
* 1.60	24	15	63	29	23	32	47	24009	0.66
* 2.50	30	19	80	37	30	41	60	24010	1.31
* 4.00	36	24	102	46	38	52	75	24011	2.69
* 4.50	42	30	126	58	47	65	94	24012	5.31
* 5.00	45	30	126	58	47	65	94	24013	5.35
* 6.30	48	30	126	58	47	65	94	24014	5.50

sizes marked * are additional and proportional to the specification

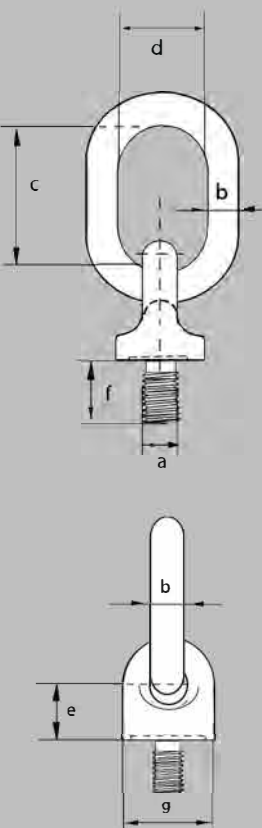

Long Shank Collared Eyebolts

c/w reeveable egglink



Material: Eyebolt: high tensile steel
 Link: high tensile steel
 Safety Factor: MBL equals 5 x SWL
 Finish: Self colour
 Certificate: This product is supplied with an EC declaration of conformity

Metric thread

safe working load	diameter thread	diameter link	length link inside	width link inside	thread length	product code	weight each
tonnes	a mm	b mm	c mm	d mm	h mm		kg
0.25	10	11	70	35	178	24301	0.47
0.40	12	11	70	35	178	24302	0.48
0.80	16	16	100	50	178	24303	1.06
1.60	20	19	120	55	178	24304	1.87
2.50	24	25	152	76	178	24305	4.16
4.00	30	32	203	98	178	24306	6.45

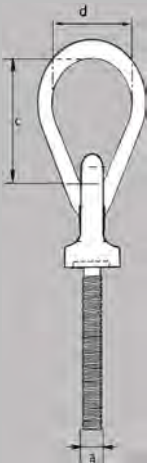

Bownuts

BSW thread

Material: High tensile steel
Safety Factor: MBL equals 5 x SWL
Standard: Generally to B.S. 3974 - Part 1 - 1974
Finish: Self colour (Electro galvanised (zinc plated) also available - prices on request)
Certificate: This product is supplied with an EC declaration of conformity



safe working load	diameter thread	diameter eye	diameter base	diameter eye inside	base height	height overall	product code	weight each
tonnes	a inch	b mm	c mm	d mm	e mm	f mm		kg
0.25	3/8	10	32	25	16	64	28501	0.15
0.50	1/2	12	38	30	17	73	28502	0.27
0.80	5/8	12	38	30	17	73	28503	0.27
1.20	3/4	14	45	40	25	102	28504	0.58
1.60	7/8	14	45	40	25	102	28505	0.58
2.20	1	17	50	50	29	124	28506	0.90
3.50	1.1/4	26	70	75	29	149	28507	2.20
4.75	1.1/2	26	70	75	29	149	28508	2.20

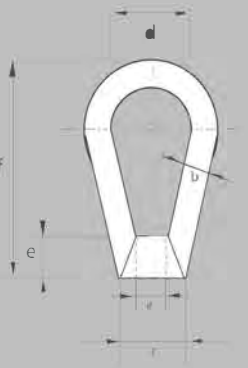

Bownuts

metric coarse

Material: High tensile steel
Safety Factor: MBL equals 5 x SWL
Standard: Generally to B.S. 3974 - Part 1 - 1974
Finish: Self colour (Electro galvanised (zinc plated) also available - prices on request)
Certificate: This product is supplied with an EC declaration of conformity

safe working load	diameter thread	diameter eye	diameter base	diameter eye inside	base height	height overall	product code	weight each
tonnes	a mm	b mm	c mm	d mm	e mm	f mm		kg
0.23	8	10	32	25	16	64	28001	0.15
0.36	10	10	32	25	16	64	28002	0.15
0.53	12	12	38	30	17	73	28003	0.27
1.01	16	12	38	30	17	73	28004	0.29
1.58	20	14	45	40	25	102	28005	0.50
2.28	24	17	50	50	29	124	28006	0.90
3.65	30	26	70	75	29	149	28007	2.20
5.34	36	26	70	75	29	149	28008	2.20

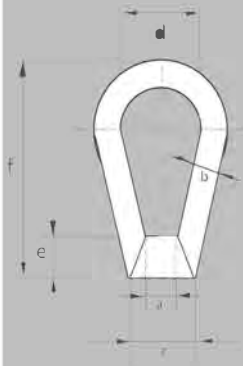



Eye nuts

BSW thread

Material: High tensile steel
Safety Factor: MBL equals 5 x SWL
Finish: Self colour (Electro galvanised (zinc plated) also available - prices on request)
Certificate: This product is supplied with an EC declaration of conformity

safe working load	diameter thread	diameter eye	diameter base	diameter eye inside	base height	height overall	product code	weight each
cwts	a inch	b mm	c mm	d mm	e mm	f mm		kg
5	3/8	13	29	44	22	78	27501	0.24
10	1/2	13	29	44	22	78	27502	0.26
16	5/8	13	29	44	22	78	27503	0.26
24	3/4	16	39	49	26	84	27504	0.45
32	7/8	16	39	49	26	84	27505	0.45
44	1	19	44	52	38	111	27506	0.79

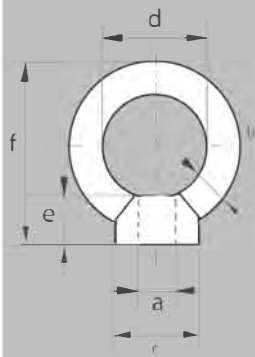



Eyenuits

metric coarse

- Material:** High tensile steel
Safety Factor: MBL equals 5 x SWL
Finish: Self colour (Electro galvanised (zinc plated) also available - prices on request)
Certificate: This product is supplied with an EC declaration of conformity

safe working load	diameter thread	diameter eye	diameter base	diameter eye inside	base height	height overall	product code	weight each
tonnes	a mm	b mm	c mm	d mm	e mm	f mm		kg
0.30	10	13	29	44	22	78	27001	0.25
0.50	12	13	29	44	22	78	27002	0.26
0.80	16	13	29	44	22	78	27003	0.27
1.20	20	16	39	49	26	84	27004	0.45
2.20	24	19	44	52	38	111	27005	0.79

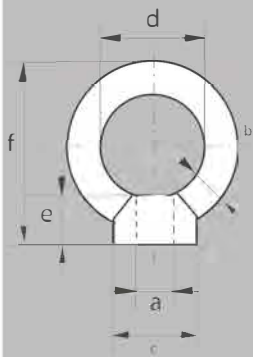

Wire Rope Grips

heavy duty

Material: Bridge - malleable steel casting
 Material: U-Bolt - mild steel
 Standard: EN 13411-5 Type A, formerly DIN 1142
 Finish: Electro galvanised



diameter wire rope	diameter bow	length bow	width inside	length thread	length base	thickness base	height base	product code	weight per 100 pieces
mm	a mm	b mm	c mm	d mm	e mm	f mm	g mm		-
5	5	25	12	14	25	13	13	31001	2
6.5	6	32	14	17	30	16	14	31002	3.66
8	8	41	18	20	39	20	18	31003	8
10	8	46	20	24	40	20	21	31004	8.8
12	10	56	24	28	50	25	24	31005	17
13	12	64	29	29	55	28	29	31006	25
14	12	66	28	31	59	30	28	31007	27.5
16	14	76	34	35	64	32	35	31008	40
19	14	83	37	36	68	33	40	31009	49
22	16	96	41	40	74	34	44	31010	62.5
26	20	111	46	50	84	38	51	31011	111
30	20	127	54	55	95	41	59	31012	144
34	22	141	60	60	105	45	67	31013	212
40	24	159	68	65	117	49	77	31014	260

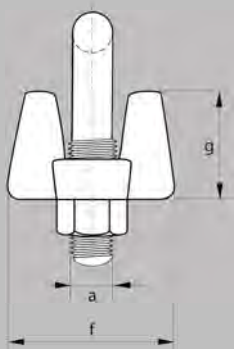
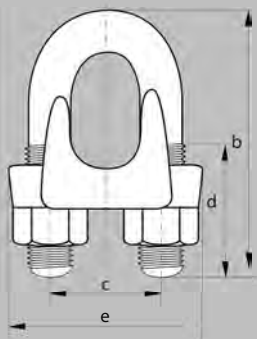

Van Beest - Closed Body Rigging Screws

Eye - Eyec/w locknuts

Material: Mild steel
 Safety Factor: MBL equals 5 x WLL, MBL equals 4 x WLL for M45 & M48
 Finish: Hot dipped galvanized
 Certificate: This product is supplied with an EC declaration of conformity
 Note: End fittings of 6 and 8mm rigging screws are electro galvanized



dia thread	length body	length closed position	length open position	dia	length eye inside	width eye inside	working load limit	product code	weight each
a mm	b mm	c mm	d mm	e mm	f mm	g mm	tons		kg
*6	100	165	245	5.5	11	11	0.20	64001B	0.13
*8	108	178	261	6	12	12	0.32	64002B	0.20
*10	125	210	308	8.5	13	13	0.50	64003B	0.60
12	195	325	484	11	30	15	0.70	64004B	0.80
16	230	380	564	12	40	20	1.20	64005B	1.40
20	270	455	673	16	50	24	1.50	64006B	2.40
22	295	495	736	16	50	24	2.20	64007B	3.00
24	325	545	806	19	56	28	3.20	64008B	4.00
33	370	665	961	29	70	35	4.80	64010B	9.00
39	400	725	1032	34	80	40	6.00	64011B	11.50
*45	407	840	1200	30	85	40	8.50	64012B	20.80
*48	407	890	1250	37	92	44	10.00	64013B	24.00

*The above sizes are supplied with Rouna Eyes

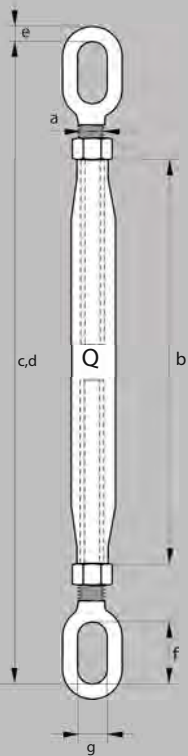

Van Beest - Closed Body Rigging Screws

Jaw - Jaw c/w locknuts

Material: Mild steel
 Safety Factor: MBL equals 5 x WLL, MBL equals 4 x WLL for M45 & M48
 Finish: Hot dipped galvanized
 Certificate: This product is supplied with an EC declaration of conformity
 Note: End fittings of 6 and 8mm rigging screws are electro galvanized



dia thread	length body	length closed position	length open position	dia pin	length inside	opening jaw	width jaw	dia jaw eye	working load limit	product code	weight each
a mm	b mm	c mm	d mm	e mm	f mm	g mm	h mm	i mm	tons		kg
6	100	175	255	5	19	7	20	13	0.20	64101B	0.16
8	108	199	282	6	25	9	24	14	0.32	64102B	0.27
10	125	222	320	8	26	10.5	28	19	0.50	64103B	0.45
12	195	320	479	10	32	13	34	22	0.70	64104B	0.85
16	230	388	572	12	39	18	42	28	1.20	64105B	1.57
20	270	454	672	16	46	20	51	33	1.50	64106B	2.67
22	295	490	730	20	55	25	55	38	2.20	64107B	3.68
24	325	558	819	22	63	30	70	46	3.20	64108B	5.30
33	370	681	977	30	85	38	82	60	4.80	64110B	12.00
39	400	710	1017	33	86	45	85	76	6.00	64111B	14.20
45	407	810	1170	39	86	48	96	80	8.50	64112B	20.80
48	407	855	1215	45	98	50	101	92	10.00	64113B	24.00

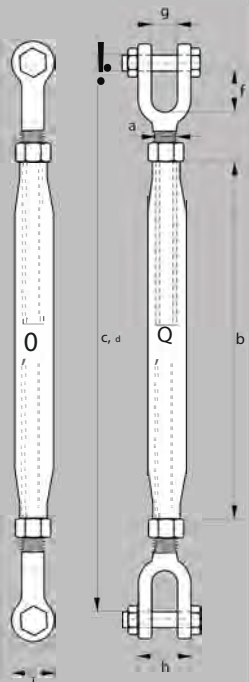

Galvanised Turnbuckles Eye - Eye

drop forged

Material: Dropforgedhightensilesteel SAE 1035 or 1045
 Safety Factor: MBL equals 5 x SWL
 Standard: Generally to ASTM F1145-92
 Formerly U.S. Federal Specification FF-T-791b
 Finish: Hotdippedgalvanised
 Certificate: This product is supplied with an EC declaration of conformity



diameter thread	take up	length closed position	length open position	dia eye	width inside eye	length inside eye	length closed position	working load limit	product code	weight each
a inches	inches	b mm	c mm	d mm	e mm	f mm	g mm	tons		kg
3/8	6	302	454	9	13	28	65	0.54	60001	0.32
1/2	6	338	490	12	18	36	80	1.00	60002	0.66
1/2	9	414	642	12	18	36	80	1.00	60003	0.76
1/2	12	490	795	12	18	36	80	1.00	60004	0.91
5/8	6	394	546	14	21	43	98	1.59	60005	1.07
5/8	9	470	698	14	21	43	98	1.59	60006	1.31
5/8	12	546	851	14	21	43	98	1.59	60007	1.71
5/8	18	701	1150	14	21	43	98	1.59	60008	1.86
3/4	6	432	584	17	25	53	113	2.36	60009	1.65
3/4	9	508	736	17	25	53	113	2.36	60010	1.95
3/4	12	584	889	17	25	53	113	2.36	60011	2.30
3/4	18	737	1194	17	25	53	113	2.36	60012	2.85
7/8	12	625	854	20	31	59	118	3.27	60013	3.33
7/8	18	778	1121	20	31	59	118	3.27	60014	4.24
1	6	524	676	22	36	74	155	4.54	60015	3.87
1	12	676	981	22	36	74	155	4.54	60016	5.09
1	18	829	1286	22	36	74	155	4.54	60017	6.00
1	24	980	1592	22	36	74	155	4.54	60018	7.52
1.1/4	12	760	1055	29	45	88	197	6.90	60019	8.12
1.1/4	18	912	1370	29	45	88	197	6.90	60020	10.40
1.1/4	24	1064	1665	29	45	88	197	6.90	60021	12.10
1.1/2	12	823	1129	32	54	105	215	9.71	60022	12.70
1.1/2	18	975	1434	32	54	105	215	9.71	60023	15.10
1.1/2	24	1127	1738	32	54	105	215	9.71	60024	17.50
1.3/4	18	1060	1533	38	60	119	254	12.70	60025	23.10
1.3/4	24	1213	1838	38	69	119	254	12.70	60026	26.30
2	24	1315	2011	45	69	146	308	16.78	60027	40.70
2.1/2	24	1486	2098	51	79	165	344	27.22	60028	64.00

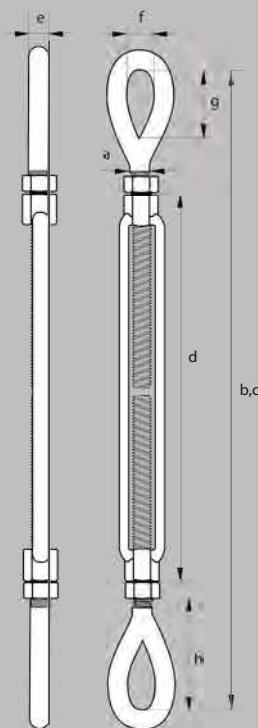

Galvanised Turnbuckles Jaw - Jaw

drop forged

Material: Dropforged hightensile steel SAE 1035 or 1045
 Safety Factor: MBL equals 5 x SWL
 Standard: Generally to ASTM F1145-92
 Formerly U.S. Federal Specification FF-T-791b
 Finish: Hotdippedgalvanised
 Certificate: This product is supplied with an EC declaration of conformity



dia thread	take up	length closed position	length open position	opening jaw	length inside	dia pin	thickness jaw eye	dia jaw eye	WLL	product code	weight each
a	b	c	d	e	f	g	h	tons		kg	
inches	inches	mm	mm	mm	mm	mm	mm				
3/8	6	302	454	13	22	8	8	21	0.54	61101	0.37
1/2	6	338	490	16	26	9.5	10	25	1.00	61102	0.73
1/2	12	490	795	16	26	9.5	10	25	1.00	61104	0.96
5/8	6	394	546	18	33	13	13	33	1.59	61105	1.37
5/8	9	470	698	18	33	13	13	33	1.59	61106	1.41
5/8	12	546	851	18	33	13	13	33	1.59	61107	1.53
5/8	18	701	1150	18	33	13	13	33	1.59	61108	1.86
3/4	6	432	584	23	38	15.5	16	41	2.36	61109	1.86
3/4	9	508	736	23	38	15.5	16	41	2.36	61110	2.31
3/4	12	584	889	23	38	15.5	16	41	2.36	61111	2.56
3/4	18	737	1194	23	38	15.5	16	41	2.36	61112	3.11
7/8	12	625	854	27	44	19	18	48	3.27	61113	3.71
7/8	18	778	1121	27	44	19	18	48	3.27	61114	4.14
1	6	524	676	30	52	22	20	54	4.54	61115	4.29
1	12	676	981	30	52	22	20	54	4.54	61116	5.07
1	18	829	1286	30	52	22	20	54	4.54	61117	6.62
1	24	980	1592	30	52	22	20	54	4.54	61118	7.85
1.1/4	12	760	1055	44	73	29	25	67	6.90	61119	9.48
1.1/4	18	912	1370	44	73	29	25	67	6.90	61120	11.60
1.1/4	24	1064	1667	44	73	29	25	67	6.90	61121	13.00
1.1/2	12	823	1129	52	70	35	27	80	9.71	61122	13.60
1.1/2	18	975	1434	52	70	35	27	80	9.71	61123	14.30
1.1/2	24	1228	1738	52	70	35	27	80	9.71	61124	18.40
1.3/4	18	1060	1533	59	85	41	33	90	12.70	61125	25.00
1.3/4	24	1213	1838	59	85	41	33	90	12.70	61126	28.70
2	24	1315	2011	64	93	41	39	108	16.78	61127	45.40
2.1/2	24	1486	2098	75	114	57	38	143	27.22	61128	73.00
2.3/4	24	1562	2171	89	110	70	42	156	34.02	61129	98.00

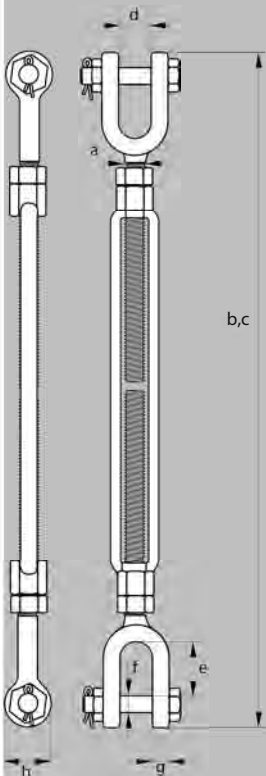



Rings

drop forged

Material: High tensile steel
Safety Factor: MBL equals 5 x WLL
Standard: B.S. 2902 - 1957
Finish: Self colour
Certificate: This product is supplied with an EC declaration of conformity

safe working load	diameter	diameter	width inside	width inside	product code	weight each
cwts	a inch	a mm	b inch	b mm		kg
11	1/2	13	2	50	79501	0.20
17	5/8	16	3	75	79506	0.42
25	3/4	19	3	76	79503	0.72
34	7/8	22	3.1/2	89	79504	1.14
44	1	25	4	100	79505	1.75

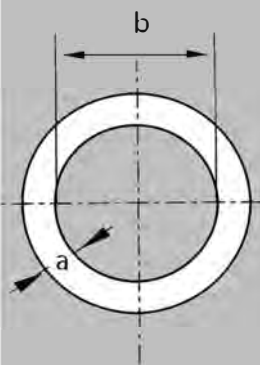

Triangular Links



drop forged

Material: High tensile steel
Safety Factor: MBL equals 5 x WLL
Standard: B.S. 2837 - Table 1 - 1988
Finish: Self colour
Certificate: This product is supplied with an EC declaration of conformity

safe working load	class	diameter	length inside	width inside	radius top	radius bottom	product code	weight each
tonnes		a mm	b mm	c mm	d mm	e mm		kg
0.32	A	10	67	67	25	8	79701	0.15
0.50	B	12	67	67	25	8	79702	0.26
0.80	C	14	67	67	25	8	79703	0.35
1.25	D	19	115	93	38	14	79704	0.90
2.00	E	22	115	93	38	14	79705	1.23
3.20	F	26	115	93	38	14	79706	1.75

* Larger sizes available - price on request

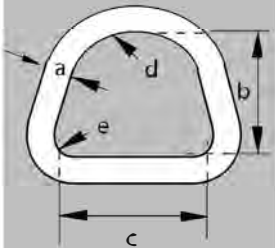

MOD Specification Deck Plates

for welding



- Material:** BS970 150 M19
Finish: Self colour, normalised condition, hardness HB159-229
Standard: To admiralty pattern, drawing 002521434
Certificate: This product is supplied with an EC declaration of conformity, upon request a material certificate
Note: This product is identified with a safe working load, however, this is subject to the correct welding procedure being carried out

proof load	AP no.	diameter		diameter eye inside	width base	length base	thickness base	height overall	product code	weight each
		a inch	a mm	b mm	c mm	d mm	e mm	f mm		
2.00	4014	3/8	10	20	25	45	6	38	79001V	0.14
3.50	4015	1/2	12	25	35	60	8	50	79002V	0.33
5.50	4016	5/8	16	32	45	70	10	64	79003V	0.53
7.50	4017	3/4	19	38	50	85	12	76	79004V	0.77
9.60	4018	7/8	22	42	60	102	13	89	79005V	1.27
13.00	4019	1	25	50	70	115	16	100	79006V	2.00
* 15.75	4020	1.1/8	28	57	76	130	18	114	79007V	2.90
20.00	4021	1.1/4	32	64	85	145	19	128	79008V	3.86
29.00	4023	1.1/2	38	76	100	170	22	152	79009V	6.58
50.00	4027	2	50	100	140	230	30	203	79010V	14.98

size marked * is additional and proportional to the specification

* Please note that Brierley Lifting Tackle Co Ltd are unable to offer any advice on welding materials or procedures

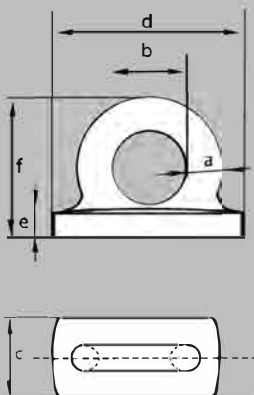



Snatch Blocks

with hook c/w safety catch

Material: Carbon steel, fitted with roller bearings, except for blocks under WLL 4 tons, these are equipped with phosphor bronze bushes

Safety Factor: MBL equals 4 x WLL

Finish: Painted blue

Certification: Blocks have been individually proof tested, as standard an EC declaration of conformity is supplied

Note: Working Load Limit is on the head fitting

Note: Measurements are for guidance only and may vary

working load limit	diameter wire rope	diameter outside sheave	length	width	width outside	product code	weight each
tonnes	mm	a mm	b mm	c mm	d mm		kg
2	7 - 9	75	290	70	80	82501	4.00
4	10 - 12	114	350	70	121	82502	5.30
8	16	152	490	93	159	82504	14.00
8	20 - 22	152	490	93	159	82503	15.00
8	20 - 22	203	540	93	210	82505	20.00
12	20 - 22	254	690	114	264	82506	36.00
15	24 - 26	305	780	130	314	82507	58.00

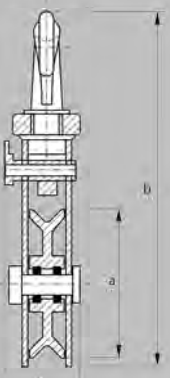
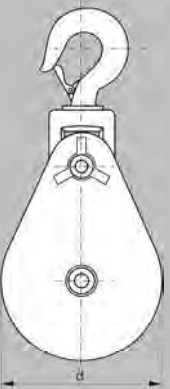

Snatch Blocks

with shackle



- Material: Carbon steel, fitted with roller bearings, except for blocks under WLL 4 tons, these are equipped with phosphor bronze bushes
- Safety Factor: MBL equals 4 x WLL
- Finish: Painted blue
- Certification: Blocks have been individually proof tested, as standard an EC declaration of conformity is supplied
- Note: Working Load Limit is on the head fitting
- Note: Measurements are for guidance only and may vary

working load limit	diameter wire rope	diameter outside sheave	length	width	width outside	product code	weight each
tonnes	mm	a mm	b mm	c mm	d mm		kg
2	7 - 9	75	280	57	80	82001	4.00
4	10 - 12	114	340	80	121	82002	5.30
8	16	152	475	125	159	82004	14.00
8	20 - 22	152	475	125	159	82003	15.00
8	20 - 22	203	530	125	210	82005	20.00
12	20 - 22	254	680	127	264	82006	36.00
15	24 - 26	305	760	127	314	82007	58.00

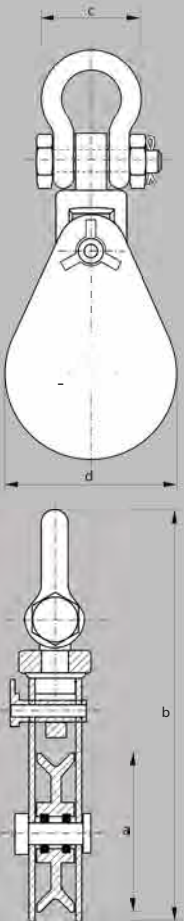

Chain Blocks

standard 3 metre height of lift, manual type

- Material:** Body - pressed steel, hooks - forged steel
Load chain - grade 8, hand chain - mild steel
- Finish:** Block - painted, load chain - black powder coated
- Certificate:** As standard an EC declaration of conformity is supplied
- Note:** Never exceed maximum capacity, measurements are for guidance only and may vary



capacity	width across (face)	width across (side)	hook admittance	length body	diameter load chain	number of falls	product code	weight each
tons	mm	mm	mm	mm	mm			kg
0.5	138	114	21	145	6	1	86101	10
1	164	124	27	182	6	1	86102	12
2	164	124	30	182	8	1	86103	24
3	198	142	37	219	8	2	86104	32
5	228	167	46	252	10	2	86105	46

Lever Hoists

1.5 metre height of lift (standard)

- Material:** Body - pressed steel, hooks - forged steel
Load chain - grade 8
- Finish:** Block - painted, load chain - black powder coated
- Certificate:** As standard an EC declaration of conformity is supplied
- Note:** Never exceed maximum capacity, measurements are for guidance only and may vary

capacity	standard lift	effort to lift load	distance between hooks	diameter load chain	number of falls	product code	weight each
kg	metre	kg	mm	mm			kg
250	1.5			4	1	86501	1.8
500	1.5			5	1	86502	4.5
750	1.5	15	295	6	1	86503	7.0
1500	1.5	23	335	8	1	86504	11.0
3000	1.5	38	405	10	1	86505	21.0
6000	1.5	39	550	10	2	86506	31.0





Wire Rope Hoists

with 20 metre rope and handle

- Material:** Body - cast
Internal components - forged and/or pressed steel
- Finish:** Painted
- Certificate:** As standard an EC declaration of conformity is supplied
- Note:** Never exceed maximum capacity, measurements are for guidance only and may vary

lifting capacity	pulling capacity	length body overall	height body overall	height hoist	width hoist	diameter rope	product code	weight per 100 pieces
kg	kg	mm	mm	mm	mm	mm		kg
800	1250	426	235	168	60	8.3	86601	12
1600	2500	545	280	190	72	11.0	86602	25
3200	5000	660	325	230	91	16.0	86603	46

Trolleys

geared

Material: Side plates - mild steel
Rollers - cast steel

Finish: Painted

Certificate: As standard an EC declaration of conformity is supplied

Note: Never exceed maximum capacity, measurements are for guidance only and may vary

working load limit	length overall	max width	height overall	width flange	product code	weight each
tons	mm	mm	mm	mm		kg
1	236	280	211	80 - 146	87202	18.0
2	273	318	236	80 - 168	87203	27.0
3	320	340	295	88 - 168	87204	34.0
5	366	365	334	100 - 170	87205	56.0



Trolleys

push travel

Material: Side plates - mild steel
Rollers - cast steel

Finish: Painted

Certificate: As standard an EC declaration of conformity is supplied

Note: Never exceed maximum capacity, measurements are for guidance only and may vary

working load limit	length overall	max width	height overall	width flange	minimum radius	eye width	product code	weight each
tons	mm	mm	mm	mm	metre	mm		kg
0.5	194	245	187	50 - 152	.8	25	87001	7.0
1.0	246	311	222	64- 203	1	30	87002	11.5
2.0	276	327	262	88- 203	1.1	38	87003	19.0
3.0	332	343	309	100- 203	1.3	40	87004	29.0
5.0	377	355	353	114- 203	1.4	50	87005	43.0

Gin Blocks

swivel round eye

Material: Body and sheave - pressed steel
Eye - forged steel

Finish: Painted green

Certificate: As standard an EC declaration of conformity is supplied



size	size	SWL	proof load	product code	weight each
mm	inches	kg	kg		kg
250	10	250	1000	88201	4.00

Three Legged Wheelbarrow Slings



Material: High tensile steel
Finish: Self colour
Certificate: As standard an EC declaration of conformity is supplied
Note: Hot dipped galvanised available - price on request

working load @ 90	proof load	product code	weight each
kgs	kgs		kg
250	500	88101	5.60